

# SEALED RIVET

Dome head

# STEEL/STEEL





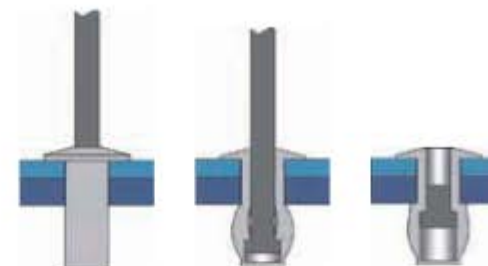
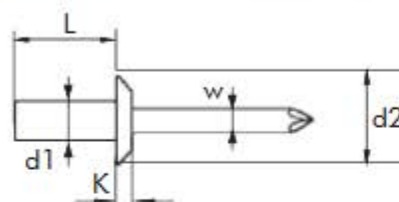

BODY: Steel Zincplated A3K

MANDREL: Steel Zincplated A3K

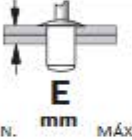

UNE - EN ISO 15976

| d1<br>Ø<br>mm | L<br>Nominal<br>mm | <br>mm | d2<br>Ø<br>mm | K<br>mm | W<br>Ø<br>mm | PACKAGING  |  | <br>E<br>mm<br>MIN. MÁX. | <br>(N) | <br>(N) | REFERENCE   |
|---------------|--------------------|---|---------------|---------|--------------|--|--|---|--|--|-------------|
|               |                    |   |               |         |              | <br>Inner | <br>Outer |   |  |  |             |
| <b>3,2</b>    | 6,0                | 3,30  | 6,50          | 1,00    | 1,90         | 500  | 4.000  | 0,5 - 1,5   | 1150   | 1300   | 01290003206 |
|               | 8,0                |   |               |         |              | 500  | 4.000  | 1,5 - 3,0   |  |  | 01290003208 |
|               | 9,5                |   |               |         |              | 500  | 4.000  | 3,0 - 5,0   |  |  | 01290003209 |
|               | 12,0               |   |               |         |              | 500  | 4.000  | 5,0 - 6,5   |  |  | 01290003212 |
| <b>4,0</b>    | 8,0                | 4,10  | 8,20          | 1,40    | 2,30         | 500  | 4.000  | 1,5 - 3,0   | 1700   | 1550   | 01290004008 |
|               | 10,0               |   |               |         |              | 500  | 4.000  | 3,0 - 5,0   |  |  | 01290004010 |
|               | 12,0               |   |               |         |              | 500  | 3.000  | 5,0 - 6,5   |  |  | 01290004012 |
|               | 15,0               |   |               |         |              | 500  | 3.000  | 6,5 - 10,5  |  |  | 01290004015 |
| <b>4,8</b>    | 9,5                | 4,90  | 9,80          | 1,70    | 2,90         | 500  | 3.000  | 1,0 - 4,0   | 2400   | 2800   | 01290004809 |
|               | 12,0               |   |               |         |              | 500  | 3.000  | 4,0 - 5,0   |  |  | 01290004812 |

Tests according to EN ISO 14589

