

STEEL/STEEL

STANDARD RIVET Dome head

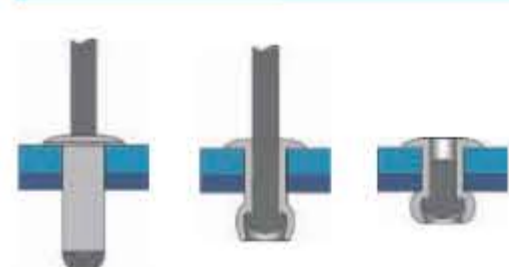

BODY: Steel Zinco-plated A3K
MANDREL: Steel Zinco-plated A1K

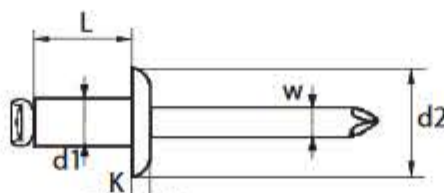

UNE - EN ISO 15979

d1 Ø mm	L Nominal mm	mm	d2 Ø mm	K mm	W Ø mm	PACKAGING		MIN. E mm	MAX. E mm	(N)	(N)	REFERENCE
						Inner	Outer					
3,0	6	3,10	6,00	1,00	2,00	500	4.000	0,5 - 3,0	950	1100	01210003006	
	8					500	4.000	3,0 - 5,0			01210003008	
	10					500	4.000	5,0 - 6,5			01210003010	
	12					500	4.000	6,5 - 8,0			01210003012	
3,2	6	3,30	6,40	1,00	2,00	500	4.000	0,5 - 3,0	1100	1200	01210003206	
	8					500	4.000	3,0 - 5,0			01210003208	
	10					500	4.000	5,0 - 6,5			01210003210	
	12					500	4.000	6,5 - 8,0			01210003212	
	14					500	4.000	8,0 - 10,0			01210003214	
	16					500	3.000	10,0 - 12,0			01210003216	
4,0	6	4,10	8,00	1,30	2,40	500	4.000	1,0 - 3,0	1700	2200	01210004006	
	8					500	4.000	3,0 - 5,0			01210004008	
	10					500	4.000	5,0 - 6,5			01210004010	
	12					500	3.000	6,5 - 9,0			01210004012	
	14					500	3.000	9,0 - 10,0			01210004014	
	16					500	3.000	10,0 - 12,0			01210004016	
	18					500	3.000	12,0 - 14,0			01210004018	
	20					500	3.000	14,0 - 16,0			01210004020	
	4,8	6	4,90	9,50	1,40	2,93	500	3.000	1,0 - 3,0	2900	3100	01210004806
		8					500	3.000	2,5 - 4,0			01210004808
10						500	3.000	4,0 - 6,0			01210004810	
12						250	2.000	6,0 - 8,0			01210004812	
14						250	2.000	8,0 - 9,5			01210004814	
16						250	2.000	9,5 - 11,0			01210004816	
18						250	1.500	10,0 - 13,0			01210004818	
21						250	1.500	11,0 - 15,0			01210004821	
24						200	1.200	15,0 - 19,5			01210004824	
30						200	1.200	19,5 - 25,0			01210004830	
35						150	900	25,0 - 30,0			01210004835	
5,0		8	5,10	9,50	1,60	2,93	500	3.000	2,5 - 4,0	3100	4000	01210005008
		10					500	3.000	4,0 - 6,0			01210005010
		12					250	2.000	6,0 - 8,0			01210005012
		14					250	2.000	8,0 - 9,5			01210005014
		16					250	2.000	9,5 - 11,0			01210005016
	18					250	1.500	10,0 - 13,0			01210005018	
	20					250	1.500	11,0 - 15,0			01210005020	
	25					200	1.200	15,0 - 19,5			01210005025	
	30					200	1.200	19,5 - 25,0			01210005030	
	35					150	900	25,0 - 30,0			01210005035	
	40					150	900	30,0 - 34,0			01210005040	
	45					100	600	34,0 - 39,0			01210005045	
	50					100	600	39,0 - 44,0			01210005050	
	60					100	600	49,0 - 54,0			01210005060	
	65					100	600	54,0 - 59,0			01210005065	
	6,0	8	6,10	12,00	1,80	3,60	250	1.500	1,5 - 3,0	4300	4800	01210006008
		10					250	1.500	3,0 - 4,0			01210006010
		12					250	1.500	4,0 - 6,0			01210006012
14						250	1.500	6,0 - 8,0			01210006014	
16						200	1.200	8,0 - 10,0			01210006016	
18						200	1.200	10,0 - 12,0			01210006018	
20						200	1.200	12,0 - 14,0			01210006020	
25						150	900	14,0 - 19,0			01210006025	
30						150	900	19,0 - 24,0			01210006030	
6,4		8	6,50	13,00	2,20	3,85	250	1.500	1,5 - 3,0	4900	5700	01210006408
	10					250	1.500	3,0 - 4,0			01210006410	
	12					250	1.500	4,0 - 6,0			01210006412	
	15					200	1.200	6,0 - 9,0			01210006415	
	18					200	1.200	9,0 - 11,0			01210006418	
	20					150	900	9,0 - 13,0			01210006420	
	22					150	900	13,0 - 16,0			01210006422	
	25					150	900	13,0 - 19,0			01210006425	
	30					100	600	19,0 - 24,0			01210006430	
	35					500		24,0 - 29,0			G1210006435	

Test according to EN ISO 14589

STANDARD RIVET Countersunk 120°

STEEL/STEEL



BODY: Steel Zinco-plated A3K
MANDREL: Steel Zinco-plated A1K

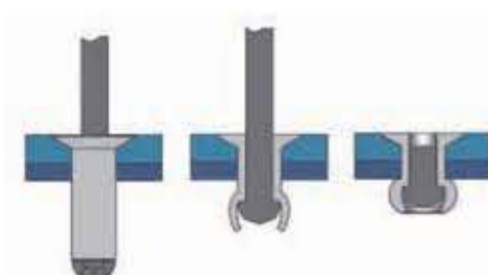
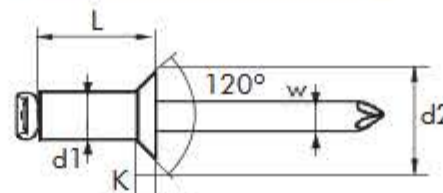

UNE - EN ISO 15980

d1 Ø mm	L Nominal mm	mm	d2 Ø mm	K mm	W Ø mm	PACKAGING		MIN. E mm	MAX. E mm	(N)	(N)	REFERENCE
						Inner	Outer					
3,2	6	3,30	6,30	1,00	2,00	500	4.000	1,5 - 3,5	1100	1200	01220003206	
	8					500	4.000	3,5 - 5,5			01220003208	
	10					500	4.000	5,5 - 7,0			01220003210	
	12					500	4.000	7,0 - 9,0			01220003212	
4,0	6	4,10	7,60	1,30	2,40	500	4.000	2,0 - 3,0	1700	2200	01220004006	
	8					500	4.000	3,0 - 5,0			01220004008	
	10					500	4.000	5,0 - 6,5			01220004010	
	12					500	3.000	6,5 - 8,0			01220004012	
	14					500	3.000	8,0 - 10,0			01220004014	
4,8	8	4,90	9,50	1,40	2,93	500	3.000	2,5 - 4,0	2900	3100	01220004808	
	10					500	3.000	4,0 - 6,0			01220004810	
	12					250	2.000	6,0 - 8,0			01220004812	
	14					250	2.000	8,0 - 10,0			01220004814	
	16					250	2.000	10,0 - 11,0			01220004816	
	18					250	1.500	11,0 - 13,0			01220004818	
	20					250	1.500	13,0 - 15,0			01220004820	
5,0	12	5,10	9,50	1,60	2,93	250	2.000	6,0 - 8,0	2900	3100	01220005012	
	25					200	1.200	15,0 - 19,5			01220005025	
6,4	10	6,50	12,50	2,00	3,85	250	1.500	3,0 - 4,0	4900	5700	01220006410	
	13					250	1.500	5,0 - 7,0			01220006413	
	16					250	1.500	8,0 - 10,0			01220006416	
	28					150	900	17,0 - 22,0			01220006428	

Tests according EN ISO 14589

STEEL/STEEL

STANDARD RIVET Large head

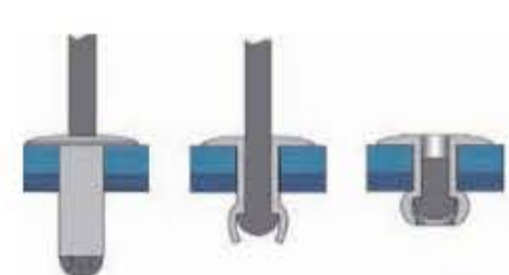

BODY: Steel Zinco-plated A3K
MANDREL: Steel Zinco-plated A1K

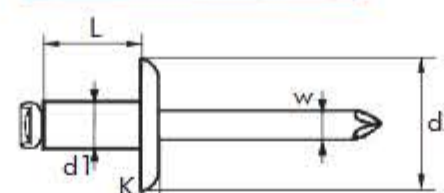

d1 Ø mm	L Nominal mm	mm	d2 Ø mm	K mm	W Ø mm	PACKAGING		MIN. E mm	MAX. E mm	(N)	(N)	REFERENCE
						Inner	Outer					
4,0	6	4,10	10,00	1,50	2,40	500	3.000	1,0 - 3,0	1700	2200	01230004006	
	8					500	3.000	3,0 - 5,0			01230004008	
	10					500	3.000	5,0 - 6,5			01230004010	
	12					500	3.000	6,5 - 9,0			01230004012	
	14					500	3.000	9,0 - 10,0			01230004014	
4,8	10	4,90	14,00	2,10	2,93	250	1.500	4,0 - 6,0	2900	3100	01230004810	
	12					250	1.500	6,0 - 8,0			01230004812	
	14					250	1.500	8,0 - 9,5			01230004814	
	16					250	1.500	9,5 - 11,0			01230004816	
	18					200	1.200	10,0 - 13,0			01230004818	
	21					200	1.200	11,0 - 15,0			01230004821	
	24					150	900	15,0 - 20,0			01230004824	
	30					150	900	20,0 - 25,0			01230004830	
	35					150	600	25,0 - 30,0			01230004835	
4,8	10	4,90	16,00	2,10	2,93	250	1.500	4,0 - 6,0	2900	3100	01240004810	
	12					250	1.500	6,0 - 8,0			01240004812	
	14					200	1.200	8,0 - 9,5			01240004814	
	16					200	1.200	9,5 - 11,0			01240004816	
	18					200	1.200	10,0 - 13,0			01240004818	
	21					150	900	11,0 - 15,0			01240004821	
24					150	900	15,0 - 19,5			01240004824		
6,4	12	6,50	19,00	3,00	3,90	1.000		4,0 - 6,0	4900	5700	G1240006412	
	15					1.000		6,0 - 9,0			G1240006415	
	18					1.000		9,0 - 12,0			G1240006418	
	30					500		19,0 - 24,0			G1240006430	

Tests according to EN ISO 14589

