

MULTIGRIP RIVET

Dome head







STEEL/STEEL

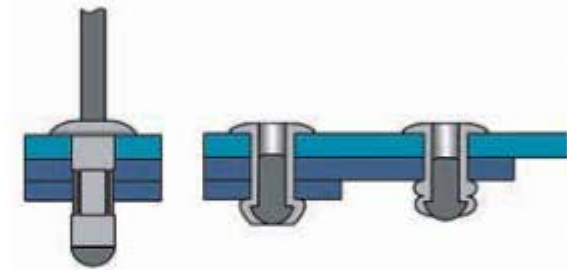
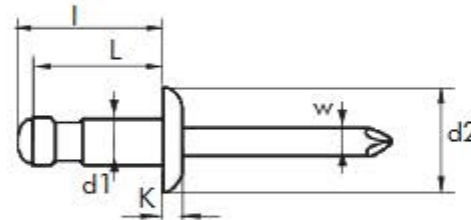

BODY: Steel Zincplated A3K

MANDREL: Steel Zincplated A1K

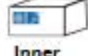

| d1 Ø mm | L Nominal mm |  mm | d2 Ø mm | K mm | W Ø mm | PACKAGING | | I Max. mm |  E mm |  (N) |  (N) | REFERENCE |
|---------------|--------------------|---|---------------|---------|--------------|--|--|-----------------|--|--|--|-------------|
| | | | | | |  Inner |  Outer | | | | | |
| 3,2 | 9,0 | 3,40 | 6,50 | 1,00 | 2,00 | 500 | 4.000 | 11,3 | 2,0 - 5,0 | 1400 | 1900 | 01280003209 |
| | 13,0 | | | | | 500 | 4.000 | 15,3 | 4,0 - 6,0 | | | 01280003213 |
| 4,0 | 11,0 | 4,10 | 8,00 | 1,40 | 2,75 | 500 | 3.000 | 14,5 | 2,0 - 5,0 | 1900 | 2500 | 01280004011 |
| | | | | | | | | | | | | |
| 4,8 | 10,5 | 4,90 | 9,50 | 1,80 | 2,93 | 250 | 2.000 | 13,0 | 1,0 - 4,5 | 2000 | 3300 | 01280004810 |
| | 13,0 | | | | | 250 | 2.000 | 16,0 | 4,0 - 6,5 | | | 01280004813 |

Tests according to EN ISO 14589

Bralo Multigrip Rivet ensures a homogeneous fastening, a firm and high quality joint that is resistant to all kinds of vibrations. Furthermore, when properly fastened, it provides a tight seal against weather conditions.

