

# MULTIGRIP RIVET

## Dome head

# ALUMINIUM/STEEL

BODY: Aluminium Al-Mg 2,5  
MANDREL: Steel Zincplated A1K

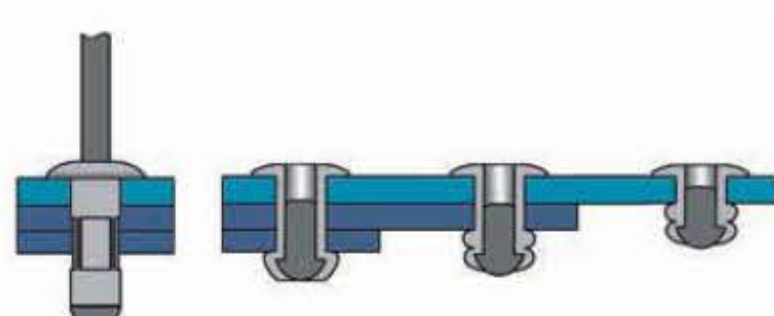
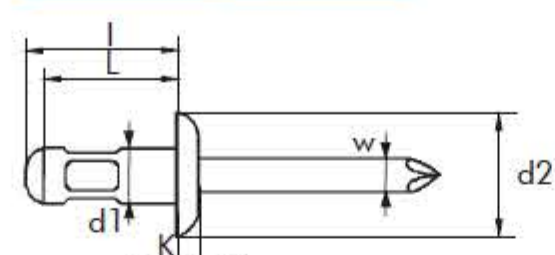

d1 Ø m/m	L Nominal m/m		d2 Ø m/m	K m/m	W Ø m/m	PACKAGING		I (MAX.) m/m	E		(N)	(N)	REFERENCE
						Inner	Outer		MIN.	MAX.			
3,2	8,0	3,30-3,50	6,20	1,10	1,80	500	4.000	10,10	0,5	5,0	630	980	01080003208
	9,5					500	4.000	11,60	1,5	6,5			01080003209
	11,0					500	4.000	13,10	4,0	8,0			01080003211
4,0	6,8	4,10-4,30	8,20	1,40	2,20	500	4.000	10,00	0,5	3,5	1050	1400	010800040068
	9,5					500	3.000	12,00	1,0	4,0			01080004009
	11,0					500	3.000	13,00	2,0	6,0			01080004011
	12,5					500	3.000	15,00	4,0	9,0			01080004012
	16,5					500	3.000	19,00	6,0	13,0			01080004016
4,8	10,5	4,90-5,10	9,90	1,60	2,75	250	2.000	14,00	1,5	6,5	1500	2300	01080004810
	15,0					250	2.000	18,00	4,5	11,0			01080004815
	16,5					250	1.500	20,00	6,5	12,5			01080004816
	19,5					250	1.500	23,00	8,5	14,5			01080004819
	24,5					200	1.200	28,00	12,5	20,0			01080004824

Tests according to EN ISO 14589



d1 Ø mm	L Nominal mm	PAINTED WHITE	PAINTED BLACK	REST OF THE	PACKAGING
		REFERENCE	RAL 9005	PAINTED COLOURS	Inner
3,2	8,5	01080 BL3208	01080 N03208	01080 3208	500 4.000
	11,0	01080 BL3211	01080 N03211	01080 3211	500 4.000
4,0	6,8	01080 BL40068	01080 N040068	01080 40068	500 4.000
	9,5	01080 BL4009	01080 N04009	01080 4009	500 3.000
	12,5	01080 BL4012	01080 N04012	01080 4012	500 3.000
	16,5	01080 BL4016	01080 N04016	01080 4016	500 3.000
4,8	10,5	01080 BL4810	01080 N04810	01080 4810	250 2.000
	15,0	01080 BL4815	01080 N04815	01080 4815	250 2.000
	16,5	01080 BL4816	01080 N04816	01080 4816	250 1.500
	24,5	01080 BL4824	01080 N04824	01080 4824	200 1.200

# MULTIGRIP RIVET

## Dome head

# ALUMINIUM/STEEL

BODY: Aluminium Al Mg 2,5  
MANDREL: Steel Zincplated A1K

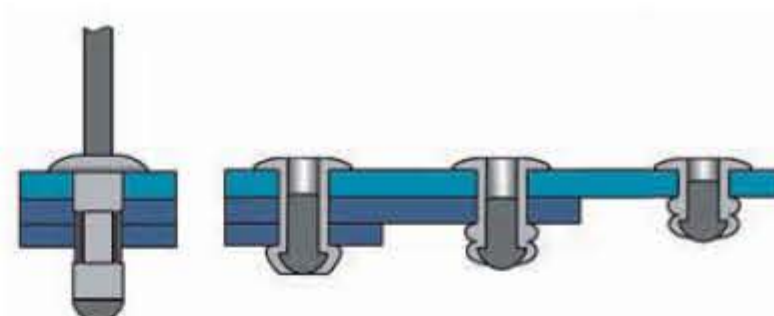
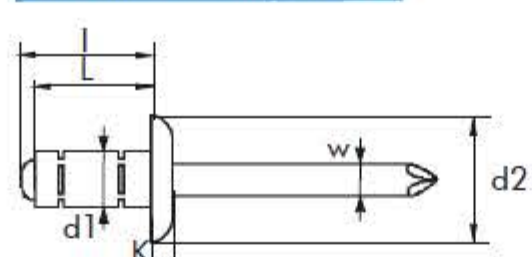

d1 Ø mm	L Nominal mm		d2 Ø mm	K mm	W Ø mm	PACKAGING		I Max. mm	E		(N)	(N)	REFERENCE
						Inner	Outer		MIN.	MAX.			
6,4	12	6,50	13,00	1,80	3,60	250	1.500	17,00	1,0 - 6,0	2800	4000	01080006412	
	15					200	1.200	20,00	4,0 - 9,0	01080006415			
	18					200	1.200	23,00	6,0 - 12,0	01080006418			

Tests according to EN ISO 14589

# ALUMINIUM/STEEL

## MULTIGRIP RIVET

### Countersunk head 120°

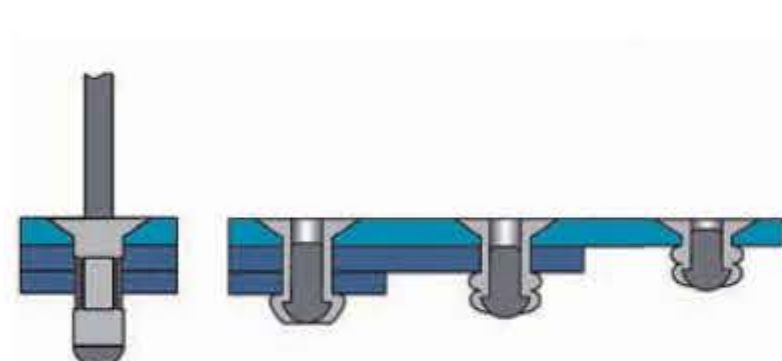

BODY: Aluminium Al Mg 2,5  
MANDREL: Steel Zincplated A1K

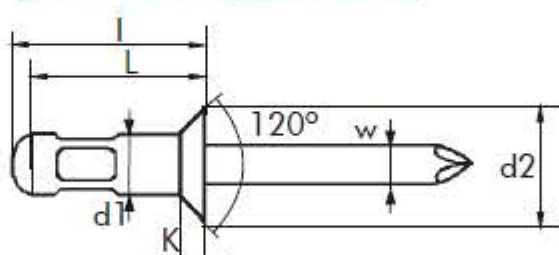

d1 Ø mm	L Nominal mm		d2 Ø mm	K mm	W Ø mm	PACKAGING		I Max. mm	E		(N)	(N)	REFERENCE
						Inner	Outer		MIN.	MAX.			
3,2	9,5	3,30-3,50	5,80	1,10	1,80	500	4.000	11,00	1,5 - 6,0	630	980	01090003209	
4,0	11,0	4,10-4,30	7,30	1,30	2,20	500	3.000	14,00	2,0 - 8,0	1050	1400	01090004011	
4,8	12,0	4,90-5,10	8,80	1,60	2,75	250	2.000	16,00	2,0 - 7,5	1500	2400	01090004812	
	16,5					250	1.500	20,00	6,0 - 12,0	01090004816			

Tests according to EN EN ISO 14589

d1 Ø m/m	L Nominal m/m	PAINTED COLOURS	PACKAGING
		REFERENCE	Inner
3,2	9,0	01090 3209	500 4.000
4,0	11,0	01090 4011	500 3.000
4,8	12,0	01090 4812	250 2.000
	16,0	01090 4816	250 1.500

# ALUMINIUM/STEEL

## MULTIGRIP RIVET

### Large head

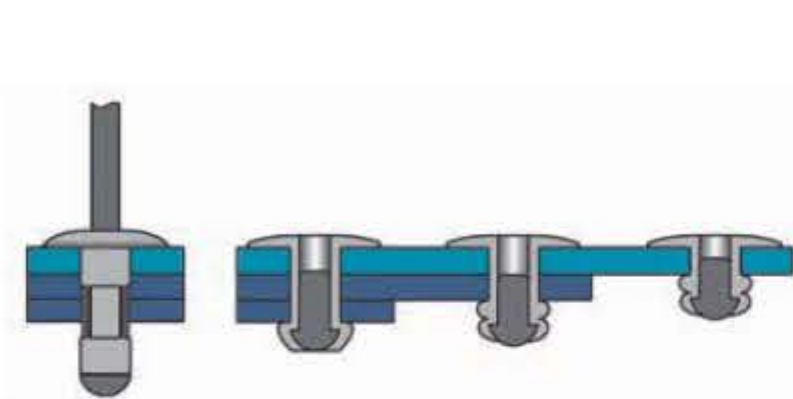

BODY: Aluminium Al Mg 2,5  
MANDREL: Steel Zincplated A1K

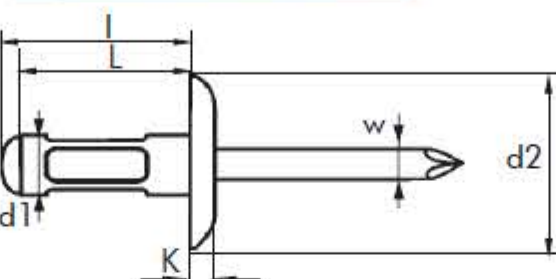

d1 Ø mm	L Nominal mm		d2 Ø mm	K mm	W Ø mm	PACKAGING		I Max. mm	E		(N)	(N)	REFERENCE
						Inner	Outer		MIN.	MAX.			
3,2	8,0	3,30-3,50	9,5	1,10	1,80	500	4.000	10,00	0,5 - 5,0	630	980	01100003208	
4,0	13,0	4,10-4,30	12,0	1,40	2,20	250	2.000	15,30	3,0 - 9,0	1050	1500	01100004013	
	16,0					250	2.000	18,80	6,0 - 13,0	01100004016			
4,8	10,5	4,90-5,10	16,0	1,80	2,75	150	900	14,00	1,5 - 6,0	1500	2400	01100004810	
	17,0					150	900	20,00	6,0 - 12,5	01100004817			
	25,0					100	600	28,00	12,0 - 19,5	01100004825			

Tests according to EN EN ISO 145

d1 Ø mm	L Nominal mm	PAINTED WHITE	PAINTED BLACK	REST OF THE	PACKAGING
		REFERENCE	RAL 9005	PAINTED COLOURS	Inner
4,0	13,0	01100 BL4013	01100 N04013	01100 4013	250 2.000
	16,0	01100 BL4016	01100 N04016	01100 4016	250 2.000
4,8	10,5	01100 BL4810	01100 N04810	01100 4810	150 900
	17,0	01100 BL4817	01100 N04817	01100 4817	150 900
	25,0	01100 BL4825	01100 N04825	01100 4825	100 600

