

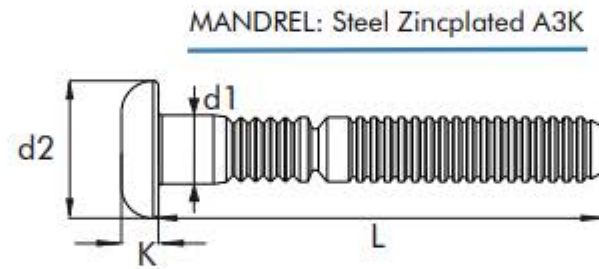

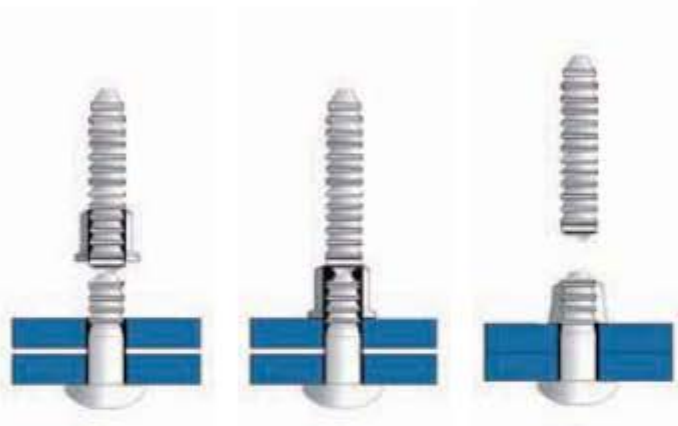



# STEEL/STEEL

## UNILOCK RIVET Lockbolt



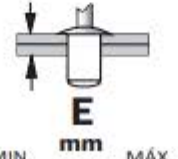

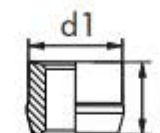
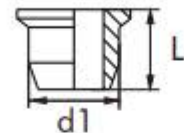

d1 Ø mm	L Nominal mm	 mm	d2 Ø mm	K mm	PACKAGING  	 E mm MIN. MÁX.	 (N)	 (N)	REFERENCE
6,5	XX	6,60	13,0	3,50	2.000	*1,5 - 30,0			0742100 65XX
	XX								0762100 65XX

4 Grooves  
6 Grooves

**Note:** This range of rivets are available under request, from a length of 3.7mm to 48 mm depending on the grip range required.



d1 Ø mm	L Nominal mm	PACKAGING  	REFERENCE
10,3	9,0	500 3.000	0732200 6509

d1 Ø mm	L Nominal mm	PACKAGING  	REFERENCE
10,3	8,0	500 3.000	0732200 6508

