

# GROOVED RIVET

Dome head



# ALUMINIUM/STEEL

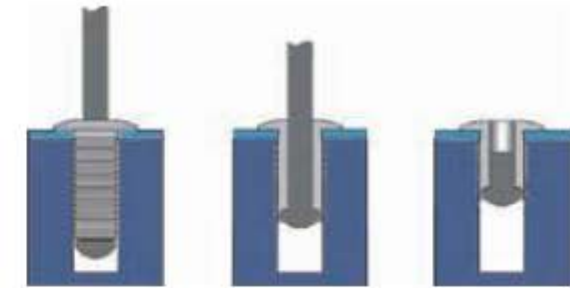
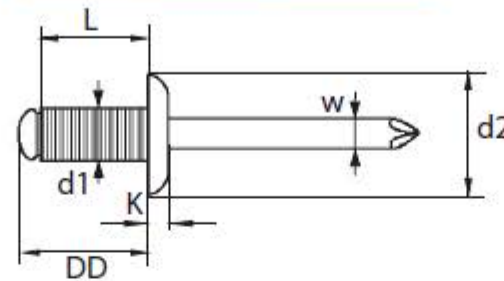

BODY: Aluminium Al Mg 3,5

MANDREL: Steel Zincplated A1K

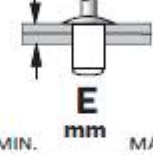

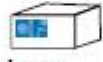
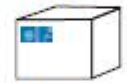
d1 Ø mm	L Nominal mm	 mm	d2 Ø mm	K mm	W Ø mm	PACKAGING		 E mm MIN. MÁX.	 (N)	 (N)	REFERENCE	DD (Drill Depth) mm
						 Inner	 Outer					
<b>3,2</b>	<b>10</b>	3,50	6,50	0,80	1,80	500	4.000	6,0	700	1100	01700003210	13
	<b>4,0</b>	<b>8</b>	4,30	8,00	1,00	2,20	500	4.000	4,0	900	1400	01700004008
						500	3.000	6,0			01700004012	15
						500	3.000	8,0			01700004016	19
<b>4,8</b>	<b>8</b>	5,10	9,50	1,10	2,73	500	3.000	4,0	1600	2600	01700004808	11
		<b>10</b>				250	2.000	6,0			01700004810	13
		<b>12</b>				250	2.000	8,0			01700004812	15
		<b>14</b>				250	2.000	10,0			01700004814	17
		<b>18</b>				250	1.500	13,0			01700004818	21
		<b>21</b>				250	1.500	15,0			01700004821	24
		<b>24</b>				200	1.200	20,0			01700004824	27

Tests according to EN ISO 14589

