

## STANDARD RIVET

Dome head

# ALUMINIUM/ALUMINIUM



BODY: Aluminium Al Mg Si

MANDREL: Aluminium

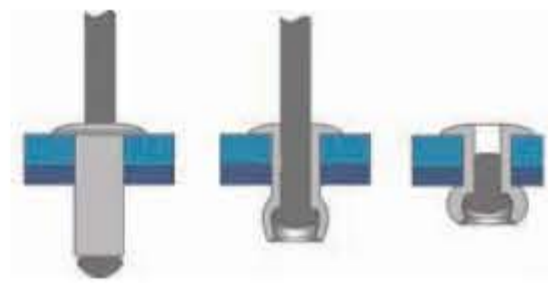
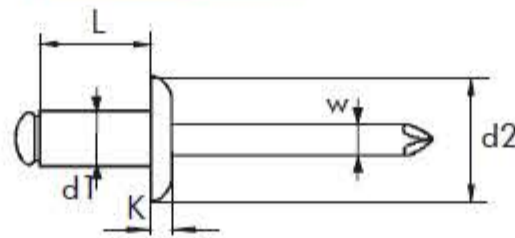

d1 Ø mm	L Nominal mm	 mm	d2 Ø mm	K mm	W Ø mm	PACKAGING		E mm		(N)	(N)	REFERENCE
						Inner	Outer	MIN.	MÁX.			
<b>3,2</b>	6	3,30	6,40	1,00	1,95	500	4.000	1,5	3,5	450	550	01160003206
	8					500	4.000	3,5	5,0			01160003208
	10					500	4.000	5,0	7,0			01160003210
	12					500	4.000	7,0	9,0			01160003212
	15					500	4.000	9,0	12,0			01160003215
	18					500	3.000	12,0	15,0			01160003218
<b>4,0</b>	6	4,10	8,00	1,20	2,45	500	4.000	1,0	3,0	680	800	01160004006
	8					500	4.000	3,0	5,0			01160004008
	10					500	4.000	5,0	6,5			01160004010
	12					500	3.000	6,5	8,5			01160004012
	14					500	3.000	8,5	10,5			01160004014
	16					500	3.000	10,5	12,5			01160004016
	18					500	3.000	12,5	14,5			01160004018
	20					500	3.000	14,5	16,5			01160004020
<b>4,8</b>	6	4,90	9,50	1,50	2,95	500	3.000	0,5	3,0	950	1200	01160004806
	8					500	3.000	2,5	4,0			01160004808
	10					500	3.000	4,0	6,0			01160004810
	12					500	3.000	6,0	8,0			01160004812
	14					250	2.000	8,0	10,0			01160004814
	16					250	2.000	10,0	12,0			01160004816
	18					250	1.500	12,0	14,0			01160004818
	21					250	1.500	14,0	17,0			01160004821
	24					200	1.200	17,0	20,0			01160004824
	27					200	1.200	20,0	23,0			01160004827
	35					150	900	27,0	30,0			01160004835

Tests according to EN ISO 14589

Note: Under request we do manufacture blind rivets aluminium/aluminium with countersunk head (d2).

## STANDARD RIVET

Large head

# ALUMINIUM/ALUMINIUM



BODY: Aluminium Al Mg Si

MANDREL: Aluminium

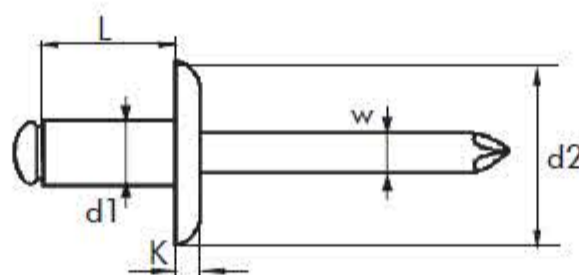

d1 Ø mm	L Nominal mm	 mm	d2 Ø mm	K mm	W Ø mm	PACKAGING		E mm		(N)	(N)	REFERENCE
						Inner	Outer	MIN.	MÁX.			
<b>4,8</b>	10	4,90	<b>14,00</b>	1,80	2,95	250	1.500	4,0	6,0	950	1200	01180004810
	12					250	1.500	6,0	8,0			01180004812
	14					250	1.500	8,0	10,0			01180004814
	16					250	1.500	10,0	12,0			01180004816
	18					200	1.200	12,0	14,0			01180004818
	21					200	1.200	14,0	17,0			01180004821
	24					150	900	17,0	20,0			01180004824
<b>4,8</b>	10	4,90	<b>16,00</b>	1,80	2,95		1.500	4,0	6,0	950	1200	G1184004810

Tests according to EN ISO 14589

